



Super Fast Recovery Rectifier

Features

- Ultrafast reverse recovery time
- Low leakage current
- Low switching losses, high efficiency
- High forward surge capability
- Glass passivated chip junction
- Solder dip 275 °C max. 7 s, per JESD 22-B106

Typical Applications

For use in high frequency rectification and freewheeling application in switching mode converters and inverters for consumer, computer and telecommunication.

Mechanical Data

Package: R-1

Molding compound meets UL 94 V-0 flammability rating, RoHS-compliant, Halogen free

Terminals: Tin plated leads, solderable per J-STD-002 and JESD22-B102

Polarity: Color band denotes the cathode end

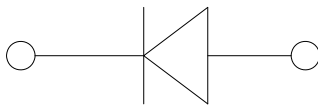

Maximum Ratings (T_a=25 Unless otherwise specified)

PARAMETER	SYMBOL	UNIT	1S1G	1S2G	1S3G	1S4G	1S5G	1S6G	1S7G	1S8Gk
Maximum Repetitive Peak Reverse Voltage	VRRM	V	50	100	150	200	300	400	500	600
Maximum RMS Voltage	VRMS	V	35	70	105	140	210	280	350	420
Maximum DC blocking Voltage	VDC	V	50	100	150	200	300	400	500	600
Average Forward Current 4 60Hz sine wave Resistance load Ta 150	I _{F(AV)}	A	1.0							
Forward Surge Current (Non-repetitive) @60Hz Half-sine wave, 1 cycle, T _j =25	I _{FSM}	A	30							
Forward Surge Current (Non-repetitive) @1ms, square wave, 1 cycle, T _j =25			60							
Current squared time @1ms t8.3 ms T _j =25 Rating of per diode	I ² t	A ² s	3.735							
Typical junction capacitance @Measured at 1MHz and Applied Reverse Voltage of 4.0 V.D.C	C _j	pF	18				12		9	
Storage Temperature	T _{stg}		-55 ~ +150							
Junction Temperature	T _j		-55 ~ +150							

Electrical Characteristics T_a=25 Unless otherwise specified

PARAMETER	SYMBOL	UNIT	TEST CONDITIONS	1S1G	1S2G	1S3G	1S4G	1S5G	1S6G	1S7G	1S8G
Maximum instantaneous forward voltage drop per diode	V _F	V	I _F =1.0A	0.95				1.3		1.7	
Maximum DC reverse current at rated DC blocking voltage per diode	I _R	μA	T _j =25	5							
			T _j =125	100							
Maximum reverse recovery time	t _r	ns	I _F =0.5A, I _R =1.0A, I _{rr} =0.25A	35							



1S1G THRU 1S8G

Thermal Characteristics $T_a=25$ Unless otherwise specified

PARAMETER	SYMBOL	UNIT	1S1G	1S2G	1S3G	1S4G	1S5G	1S6G	1S7G	1S8G
Typical Thermal Resistance	R J-A	/W	95							

Ordering Information (Example)

PREFERRED P/N	PACKAGE CODE	UNIT WEIGHT(g)	MINIMUM PACKAGE(pcs)	INNER BOX QUANTITY(pcs)	OUTER CARTON QUANTITY(pcs)	DELIVERY MODE
1S1G~1S8G	D1	Approximate 0.19	5000	5000	50000	Tape
1S1G~1S8G	C1	Approximate 0.19	1000	1000	50000	Bulk

Characteristics(Typical)

Instantaneous Forward Current (A)

Instantaneous Forward Voltage (V) For \varnothing S 0



1S1G THRU 1S8G

FIG.5: Diagram of circuit and Testing wave form of reverse recovery time

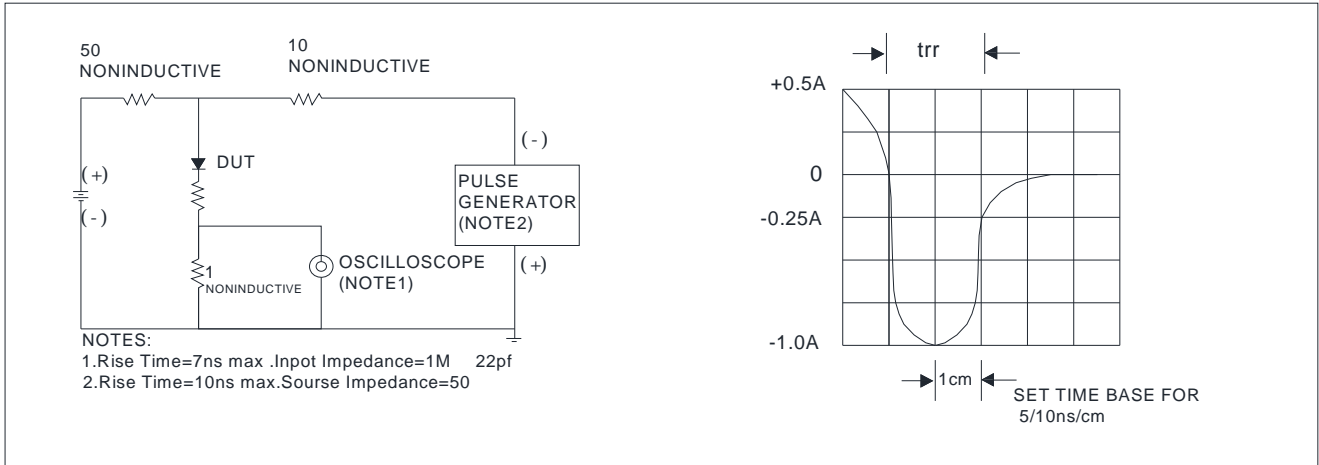

Outline Dimensions

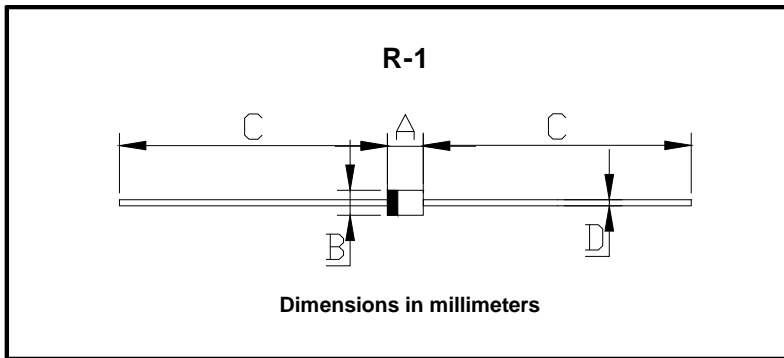

R-1		
Dim	Min	Max
A	3.00	3.30
B	2.00	2.70
C	25.4	/
D	0.53	0.64



1S1G THRU 1S8G

Disclaimer

The information presented in this document is for reference only. Yangzhou Yangjie Electronic Technology Co., Ltd. reserves the right to make changes without notice for the specification of the products displayed herein to improve reliability, function or design or otherwise.

The product listed herein is designed to be used with ordinary electronic equipment or devices, and not designed to be used with equipment or devices which require high level of reliability and the malfunction of which would directly endanger human life (such as medical instruments, transportation equipment, aerospace machinery, nuclear-reactor controllers, fuel controllers and other safety devices), Yangjie or anyone on its behalf, assumes no responsibility or liability for any damages resulting from such improper use of sale.

This publication supersedes & replaces all information previously supplied. For additional information, please visit our website [http:// www.21yangjie.com](http://www.21yangjie.com) , or consult your nearest Yangjie's sales office for further assistance.